



Rimage Surveillance Solutions:

Rimage Surveillance Software Suite

With a growing number of digital surveillance cameras, increased image quality and recording required, along with complicated retention requirements, organizations and companies are facing critical data management and archiving strategy challenges. Most are asking the same question; “Do I purge my data and potentially lose critical content, or do I keep adding physical storage?”

A leader in software solutions targeting storage and distribution of digital content, Rimage has developed an integrated solution that solves critical content distribution and long term archiving issues in the surveillance industry. Rimage Surveillance “Publisher” and Rimage Surveillance “Archiver” completely automates the process of exporting content for publishing and managing long-term archiving to DVD and/or Blu-ray™ Disc (BD) media.



Rimage Surveillance Solutions utilize evidentiary grade DVD and BD media. This high-quality media enables users to securely and cost effectively distribute content as needed and to archive video data for extended periods or permanent storage. Every disc contains user defined content along with a viewer. This enables users to easily view content on any Windows based computer with a DVD or Blu-ray drive.

Rimage Surveillance Software Suite Features

Rimage software modules have the flexibility and power to integrate into almost any workflow and process. Rimage software adapts to end user needs and workflow instead of requiring them to adapt to use a Rimage disc publishing system. The result is a dramatic decrease in the time and expense of managing complex processes.

The Rimage Surveillance Publisher and Surveillance Archiver are feature rich solutions that fit into all workflows, from simple to the most complex.



Rimage Surveillance Publisher Software

Rimage Surveillance Publisher software is part of the Rimage Surveillance Software Suite. Rimage Surveillance Publisher seamlessly integrates into the Milestone SmartClient. This integration enables any user to browse content and use standard SmartClient tools to export any number of video clips. After the exports complete, the Rimage Surveillance Publisher prompts the user to select specific data sets to publish on DVD or BD. With only 2 clicks of the mouse users start the publishing job running in the background, freeing them to review additional surveillance content or perform other important operator functions.

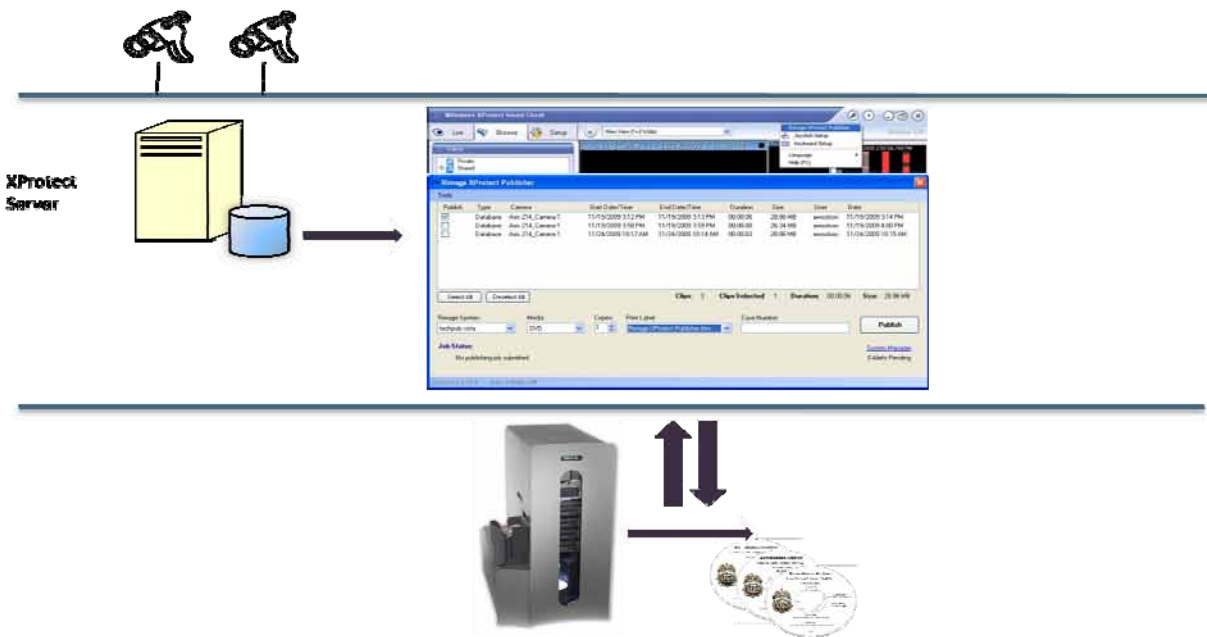

Rimage Surveillance Publisher

- Quickly exports surveillance video and automatically publishes it to DVD or Blu-ray media.
- Automatically captures and prints video export meta-data directly on the disc for easy identification.
- Automatically spans large datasets to multiple DVD or Blu-ray Discs.
- Includes the Milestone XProtect viewer on each completed disc enabling the exported content to be viewed on any Windows based computer with a DVD or Blu-ray player.



Rimage Surveillance Archiver Software

Rimage Surveillance Archiver software is part of the Rimage Surveillance Software Suite. Rimage Surveillance Archiver seamlessly integrates into the Milestone XProtect Enterprise platform. This application enables the administrator to create a unique archive schedule for each individual camera, based on a date/time or an archive size trigger point. After the schedule has been established, the Rimage Surveillance Archiver automatically processes each scheduled event. The end result is a long term archive with no user intervention required. This automated process eliminates errors due to training or personnel issues.

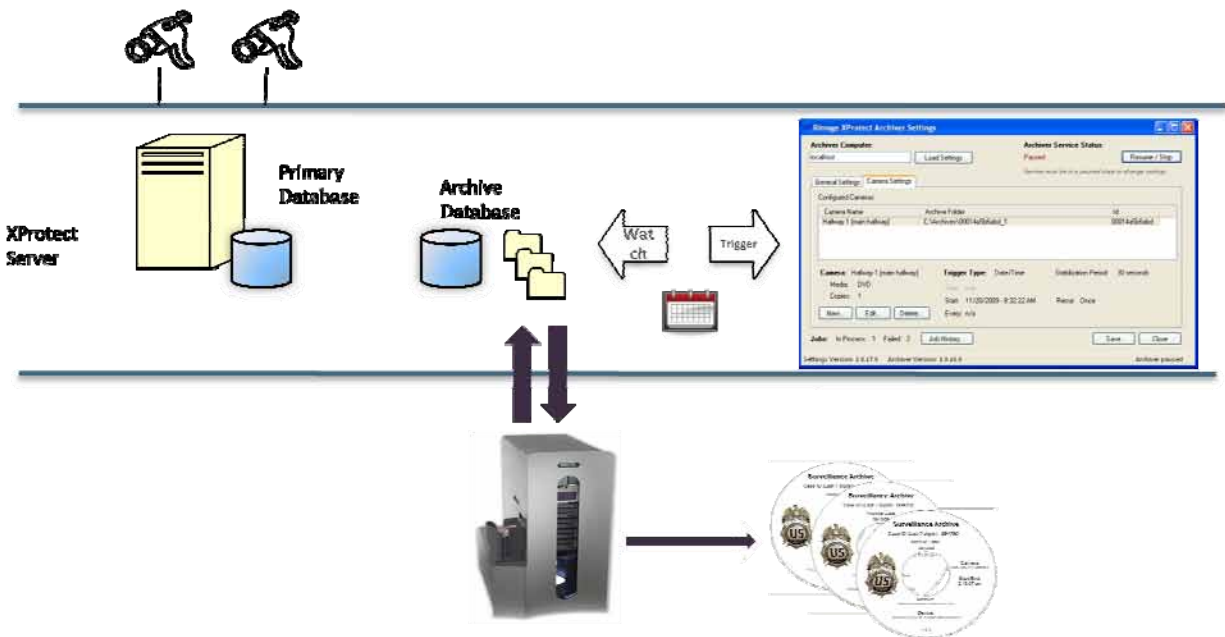

image Surveillance Archiver Features

- Runs as a Windows service monitoring and archiving surveillance.
- Archiver monitors specific camera archive locations and automatically archives to DVD or BD on a set schedule based on size or date/time.
- Administrator console to create/modify/delete archive schedules.
- Automatically captures and prints video export meta-data on disc for easy identification.
- Automatically spans large datasets to multiple DVD or BD media.
- Records surveillance content and the Milestone XProtect viewer on each disc. This enables archived content to be viewed on any Windows based computer with a DVD or Blu-ray drive/player.



Rimage Surveillance Software Suite Summary

- Completely hands free operation cuts labor and errors
- Low cost per terabyte of storage saves money
- Provides automated online and backup management
- Retention and destruction requirements can be easily met – every time
- Blu-ray Discs (25Gb and 50Gb capacities) meet all workflow requirements
- Evidentiary grade direct-to-disc printing and data protection
- Intelligent labeling: Optical disc is the only media type that has enough space on the media surface to clearly and permanently display recorded content without having to mount the disc, drive, or tape.
- Provides a seamless workflow integration

Rimage Everest™ Direct-to-disc Printing

State-of-the-art Rimage Everest thermal retransfer printer technology allows the printer to begin the print process while the disc is still in the recorder, significantly increasing throughput. The printer sets a new standard for quality, delivering the most durable discs and highest print resolution in the industry. Text and artwork are permanently fused to the surface of the disc. No other print technology matches the print resolution, print speed, or durability of an Everest printer.

- The Everest 600 has the highest print resolution in the industry—600 dpi—delivering photo quality images, with sharpness and detail that are not available in other print technologies.
- Thermal retransfer print technology produces printed images that are scratch-proof, waterproof, fade resistant, UV protected, and will last the life of the disc.

Rimage GSA Schedule

Rimage systems and software are on GSA schedule. Local, state, and federal agencies, along with many classes of contractors and educational facilities, are authorized to buy off the GSA schedule. Please consult your systems procurement office for details about the easy-to-use GSA program.





More About Rimage

Rimage digital publishing systems are the gold standard for digital asset management, disc publishing and printing. With decades of systems and software development, we are the market leader in automated digital publishing and provide unparalleled global service and support. Businesses throughout the world rely on Rimage systems— from day-to-day disc publishers to organizations that duplicate and print a variety of media as a mission-critical component of their daily operations.

Rimage offers a variety of system configurations to meet a wide range of disc production requirements—for different content types, large and small volumes, and all disc formats, such as CD, DVD, or BD. Whether you need business-wide networking or a fully customized, integrated solution, we will work with you to achieve your goals. Rimage stands behind every installation, providing media kits that guarantee the quality of your output and technical support that is unmatched in the industry

Rimage Surveillance Software Suite





Rimage Surveillance Publisher

- Windows XP Professional SP3, Windows Server 2003, or Windows Vista with SP1
- Milestone Surveillance Enterprise (XPE) version 6.5x.
- Rimage Producer Suite (PSS) version 8.2x.
- Milestone Smart Client Version 3.6f.

Rimage Surveillance Archiver

- Windows XP Professional with SP3, Windows Server 2003, or Windows Vista SP1
- Milestone XProtect Enterprise (XPE) version 6.5x.
- Rimage Producer Suite (PSS) version 8.2x.

Supported Rimage Publishing Systems:

	Rimage 5400N	Rimage 6100N	Rimage 7100N	Rimage 8100N
Features				
Printer	Everest 400	Everest 600	Everest 600	Everest 600
Input Capacity	100	300	300	300
Recorders (BD/DVD/CD)	2	1	2	4
Network Software	Producer Software Suite	Producer Software Suite	Producer Software Suite	Producer Software Suite
Integrated PC	Yes	Yes	Yes	Yes
Internal Storage	1 TB minimum	1.5 TB minimum	1.5 TB minimum	1.5 TB minimum
Network Connectivity	1 GB Ethernet	1 GB Ethernet	1 GB Ethernet	1 GB Ethernet
Daily throughput	4 TB per day	3 TB per day	6 TB per day	9 TB per day

Rimage Corporation

7725 Washington Avenue South
 Minneapolis, Minnesota 55439 USA
 Toll Free: 800.445.8288
 Tel: 1.952.944.8144
 Fax: 1.952.944.7808
www.rimage.com

Rimage Europe

Rimage Europe GmbH
Albert-Einstein-Strasse 26
63128 Dietzenbach, Germany
Tel: (49) (0) 6074 8521 0
Fax: (49) (0) 6074 8521 100
www.rimage.eu

Rimage Asia/Pacific

Rimage Japan Co., Ltd.
 2F., WIND Bldg.
 7-4-8 Roppongi Minato-ku,
 Tokyo 106-0032 JAPAN
 Tel: +81.3.5771.7181
 Fax: +81.3.5771.7185
www.rimage.co.jp